

E-pathy City

同理 · 城市

17/04/2023 Prof. Wallace Chang Ping Hung

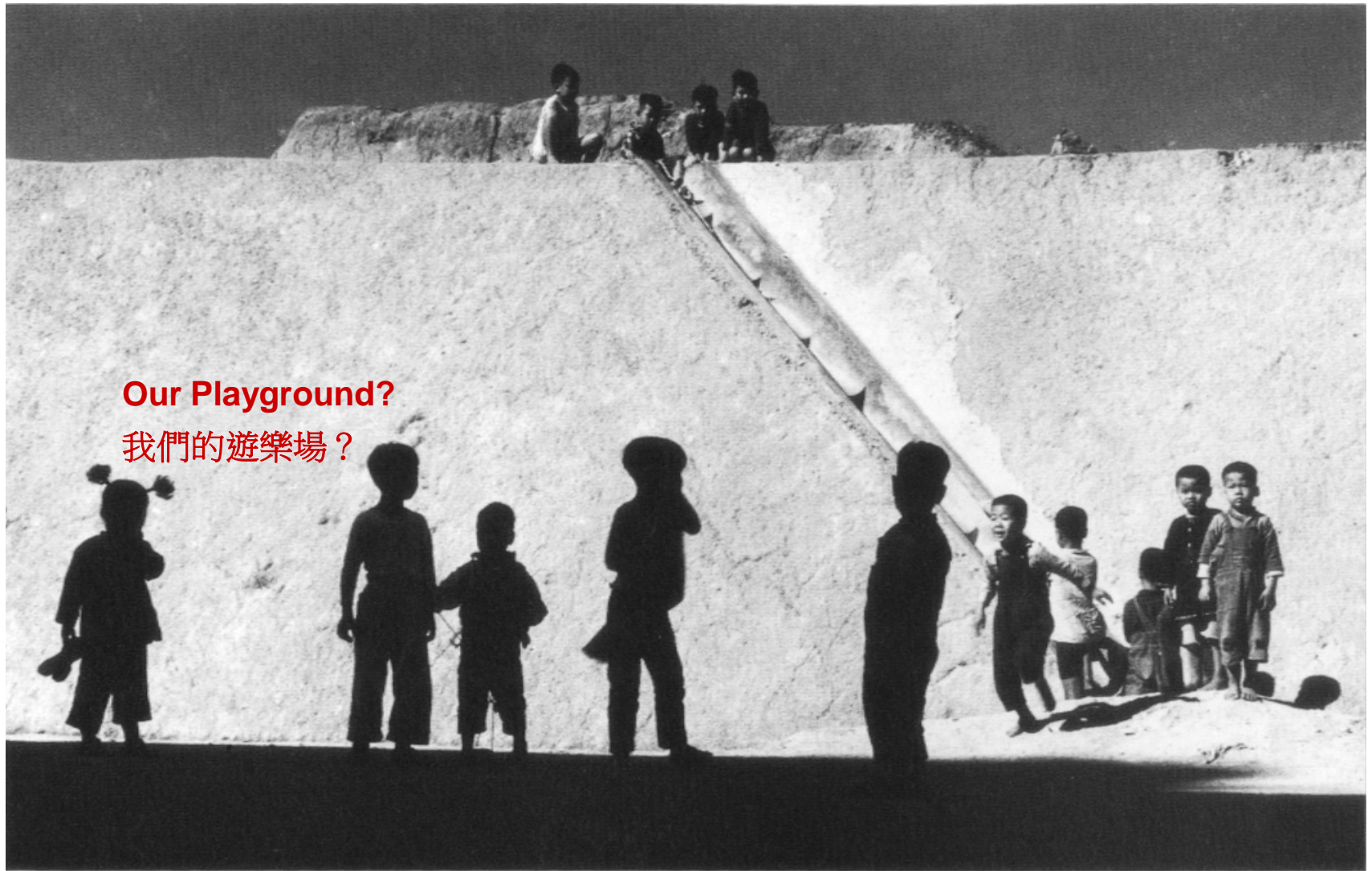

Our Playground?

我們的遊樂場？

Conductive Adaptation
誘發適應





Our Field ?
我們的場地？

Dai Mui



Our School?
我們的學校？

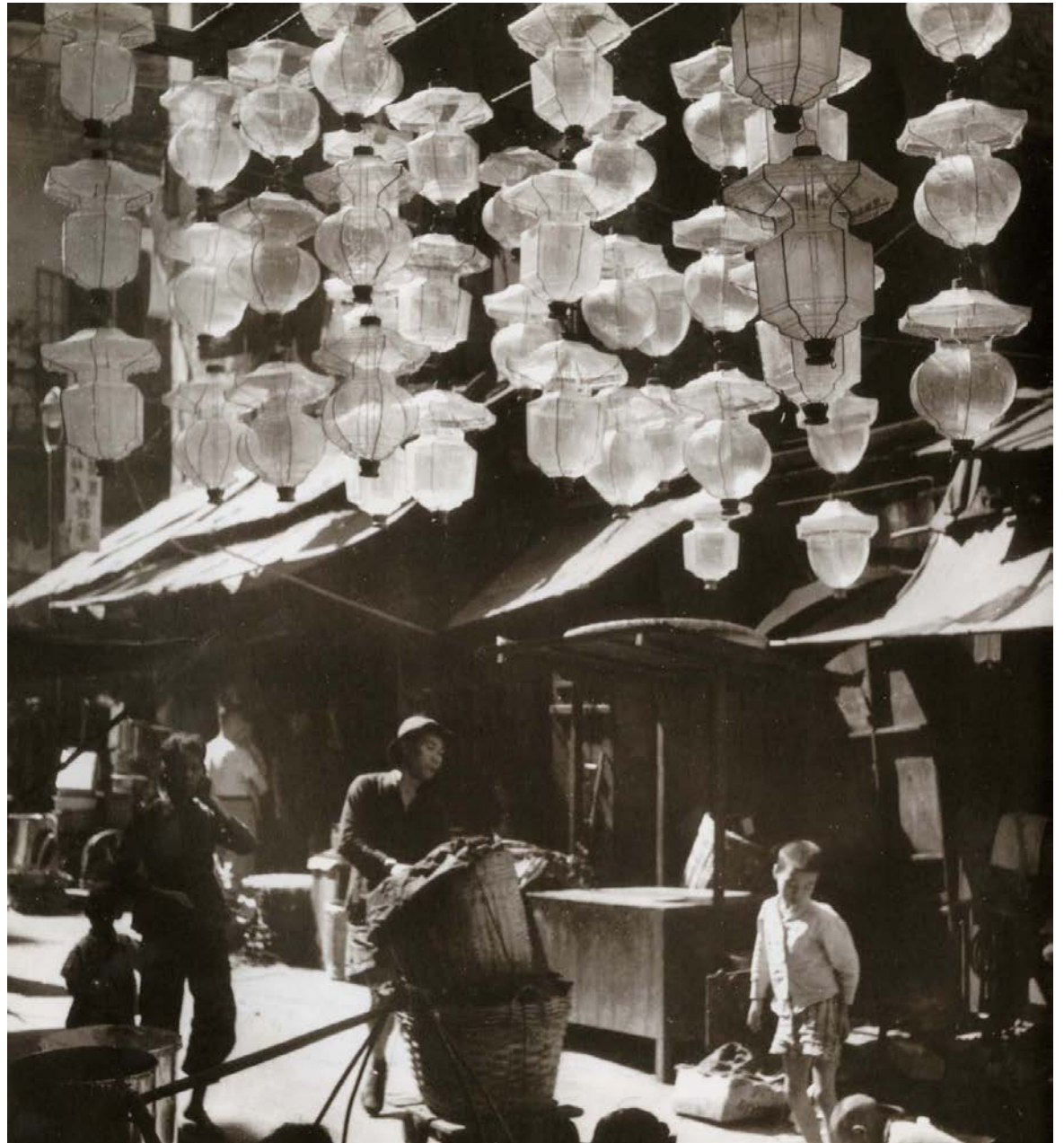

Spatial Interpretation
空間詮釋

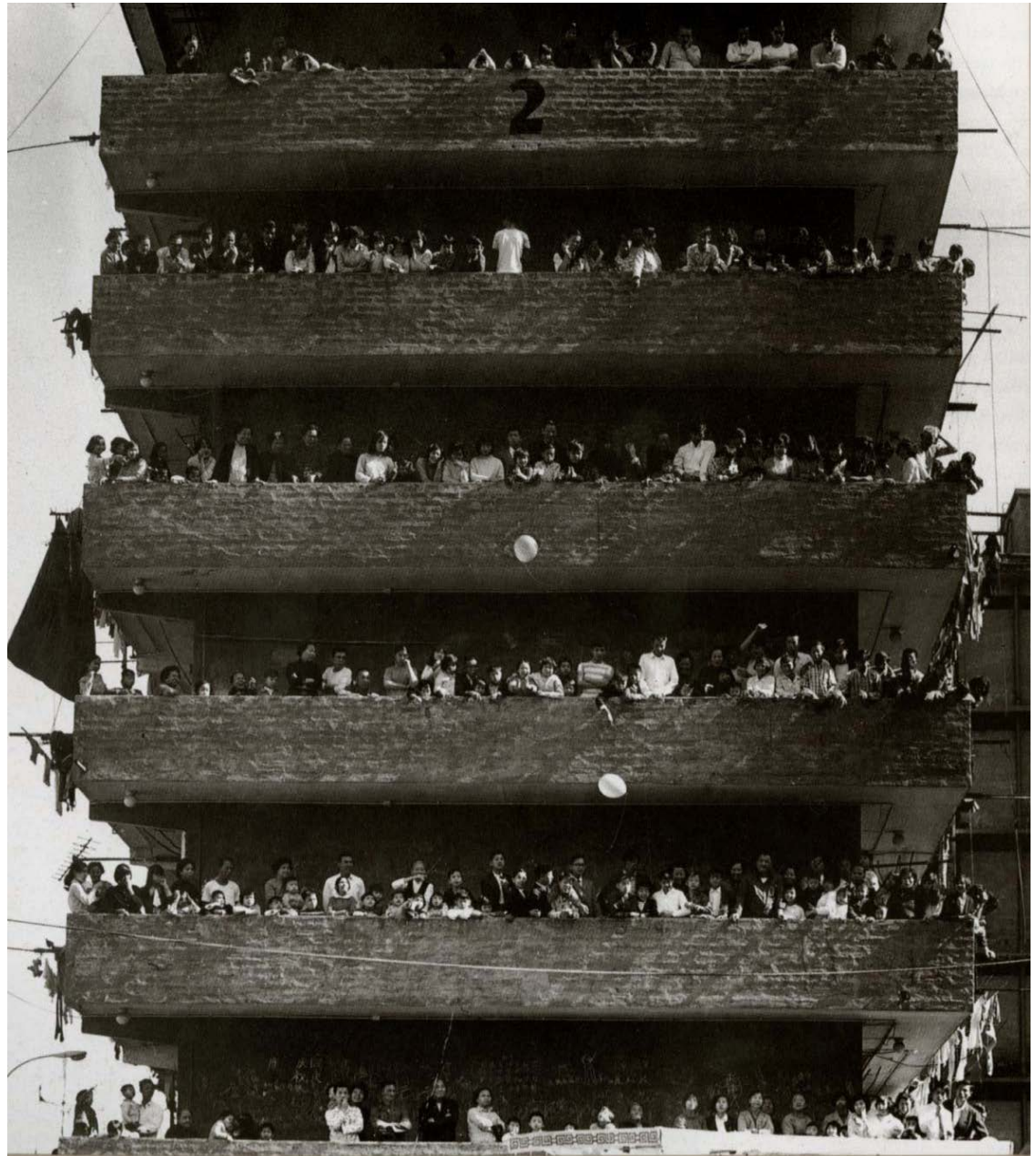

[vertical freespace]



-Hong Kong is entering into a fast growing stage of “Ageing Society”

% of Ageing Population in Overall

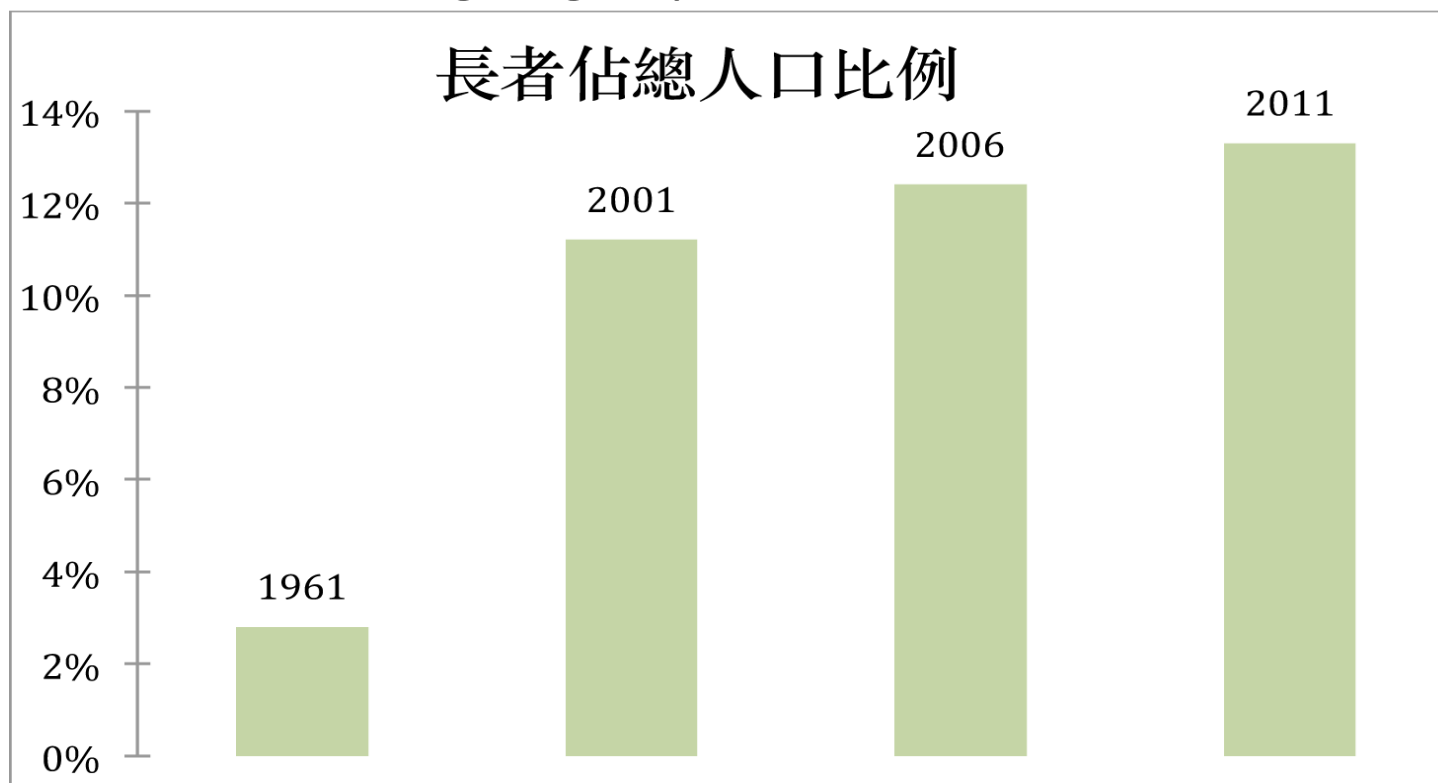

- To recognize the social issue of “Increase of Dependency Ratio” due to the growing Ageing Population

Elderly Dependency Ratio

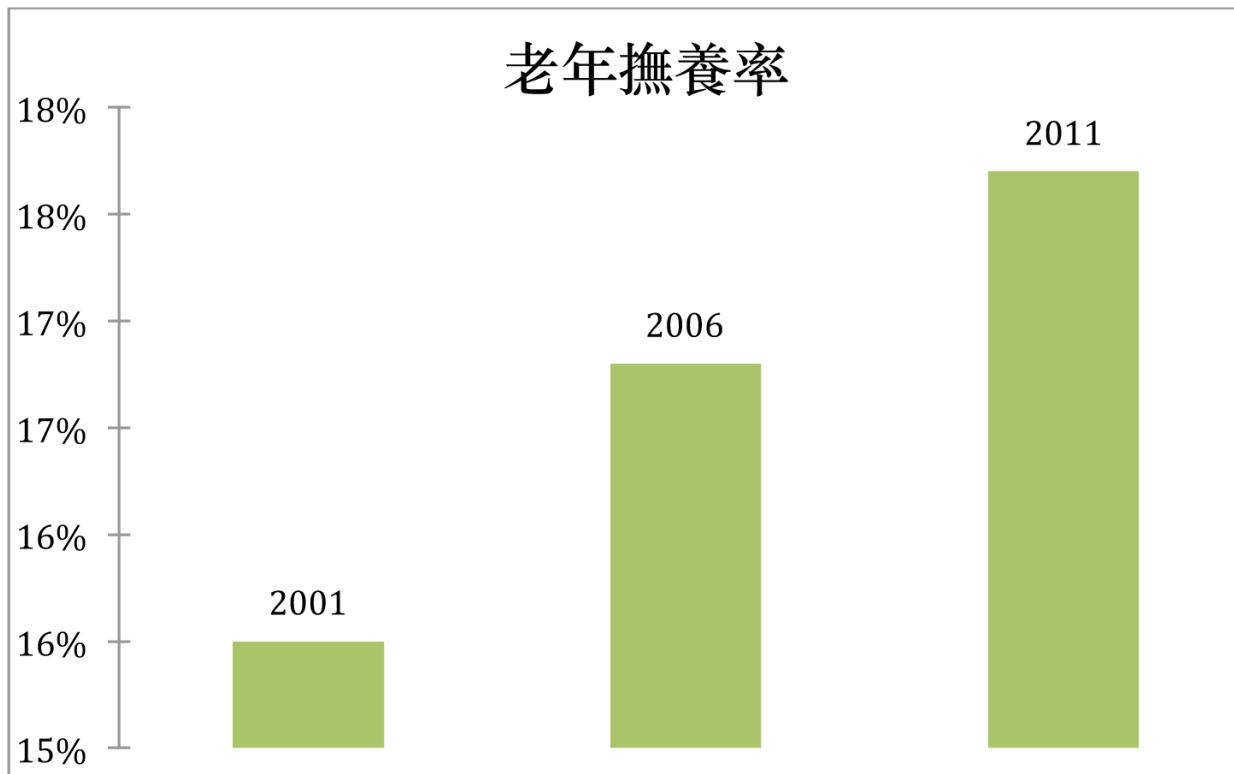

HK Home Alone Elderly is growing

% Single-living elderly

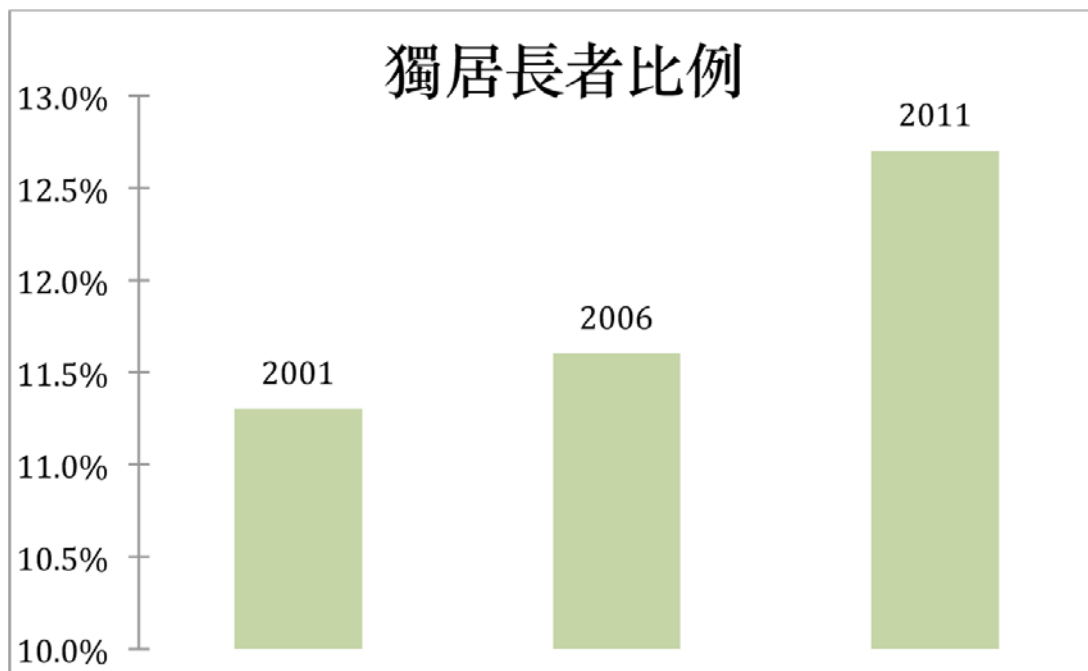



? Tradition

a room to reflect
who and where we
were



! Contemporary

a room to reflect
who and where we
are

Making Room for Us

NINE SONGS IN A SMALL ROOM

1

GENEROSITY

Making room for a small universe takes practices of solitude; when the world is pushing for Bigness, we are standing still for where we dwell.

Small as usual, but can it be beautiful?

2

EARTH & HEAVEN

Making room for an absorbing ethos means focus from distraction; when people beyond the walls are creating Chaos, we are listening to pulses of where we begin.

Small as usual, but can it be silent?

3

SHARING & ENGAGING & CROSS OVER

Making room for a resting body follows hours of labour; if the floors are elevating from Earth, we are lying only on where we set.

Small as usual, but can it be flat?

4

FREEDOM TO IMAGINE

Making room for a viewing sight bears burdens of emptiness; for the windows are facing Darkness, we are looking towards where we end.

Small as usual, but can it be blank?

5

TIME & MEMORY & NOW

Making room for a loving hug gives excuses of posture; if the ceilings are embracing Heaven, we are hearing where we breathe.

Small as usual, but can it be airy?

6

SPIRITUALITY

Making room for a daunting meal needs loads of displacement; for the beds are folding Twins, we are eating on where we read.

Small as usual, but can it be double?

7

FREE SPACE

Making room for a killing fight lends fires of anger; when the doors are opening Secrets, we are breaking out where we enter.

Small as usual, but can it be harder?

8

HUMANITY

Making room for a dying soul begs for tears of mercy; when the roofs are lifting Heights, we are looking upon where we fly.

Small as usual, but can it be finite?

9

COMMUNITY

Making room for the people is once for all; when the rooms are housing Us, we are seeking where we belong.

Small as usual, but can it be HOME?

念。斗室

1。寬納

念斗室宙宇若塵，常習鍊獨處；
每當世界求大，且穩住居安。
室斗如斯，何以美之？

2。天地

念斗室思潮起伏，難排散凝聚；
縱然藩籬踳亂，可聆聽初衷。
室斗如斯，何以靜之？

3。融和

念斗室休頓形軀，隨劬勞日久；
若夫脫離塵土，或安躺原位。
室斗如斯，何以坦之？



4。想像

念斗室管中窺豹，負虛空擔重；
可知窗外幽幽，盡眺望終歸。
室斗如斯，何以明之？

5。記憶

念斗室抱夢相擁，借騷弄因由；
假裝傘蓋蓬萊，定恭聞納息。
室斗如斯，何以暢之？

6。靈性

念斗室饕餮飽腹，須大費周章；
雖則襟飪兩生，願同餐共寢。
室斗如斯，何以雙之？





7。自由

念斗室殺破狼藉，惹怒火衝冠；
何不開門見山，頓踏出空門。
室斗如斯，何以重之？

8。人性

念斗室元神彷彿，求慈悲淚盈。
若非頂隔千丈，早展翅遨翔。
室斗如斯，何以限之？

9。眾生

念斗室，一往眾生；
即使窩居我處，非尋尋覓覓。
室斗如斯，可以為家？



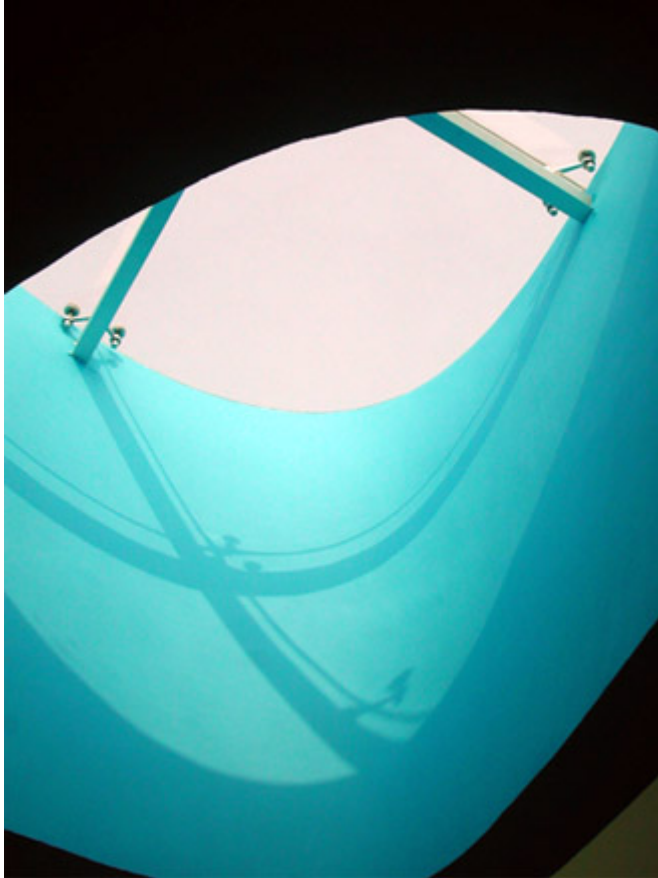









[intellect-act]



- 
- “Rooms for Elderly” Manifesto (2015)
 - “Architect” as “Social Reformer”

[making room for ---. hong kong]

Art Exhibition at 1A Space on 'Small Living'
Hong Kong





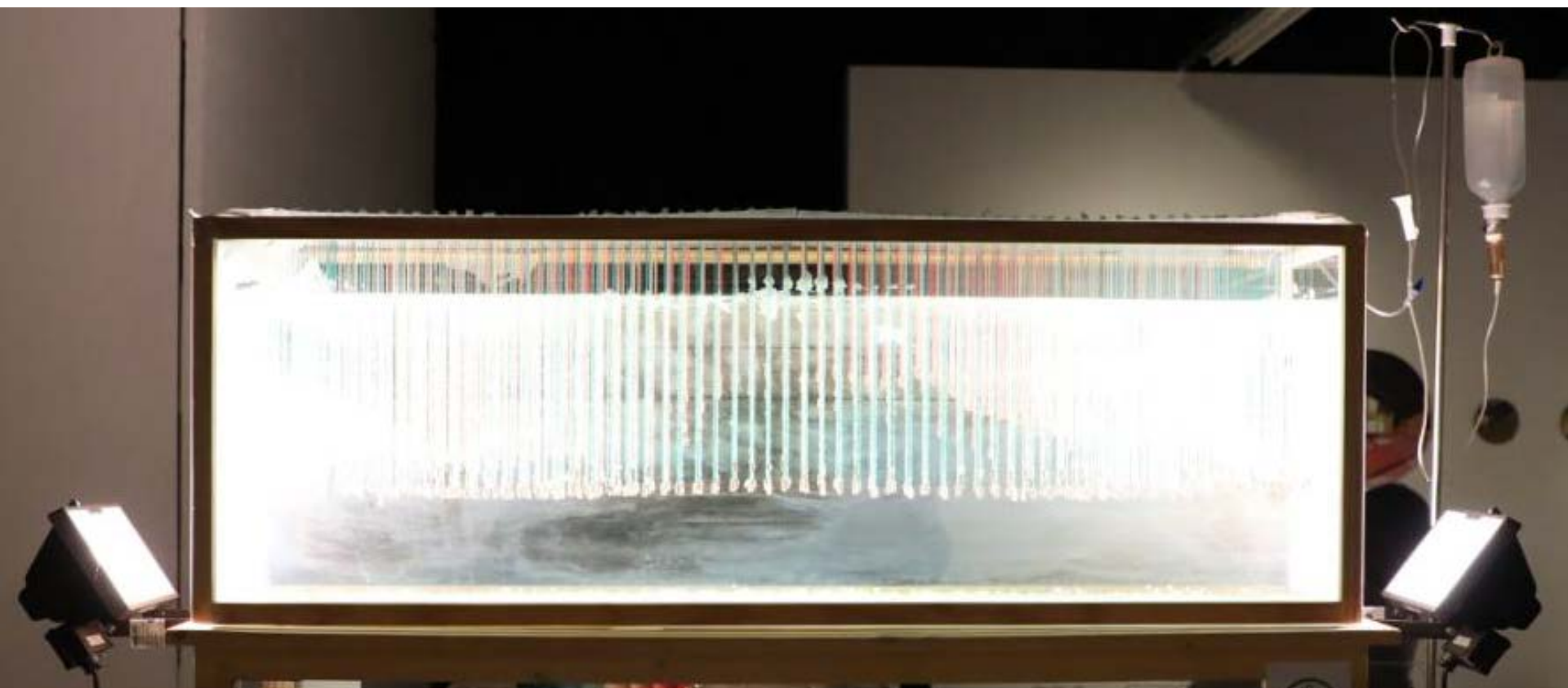

[e-pathy city--
open, connected, free spirit]



E-pathy City

ART

GREEN

ELDERLY

The Way

- According to our observation, HK young generation is not willing to stay with their parents. Due to limitation of spaces, and more of privacy, but they are also affected by the **traditional Chinese concept**, the young people after marriage or independence, they are willing to keep close contact and care for their parents.

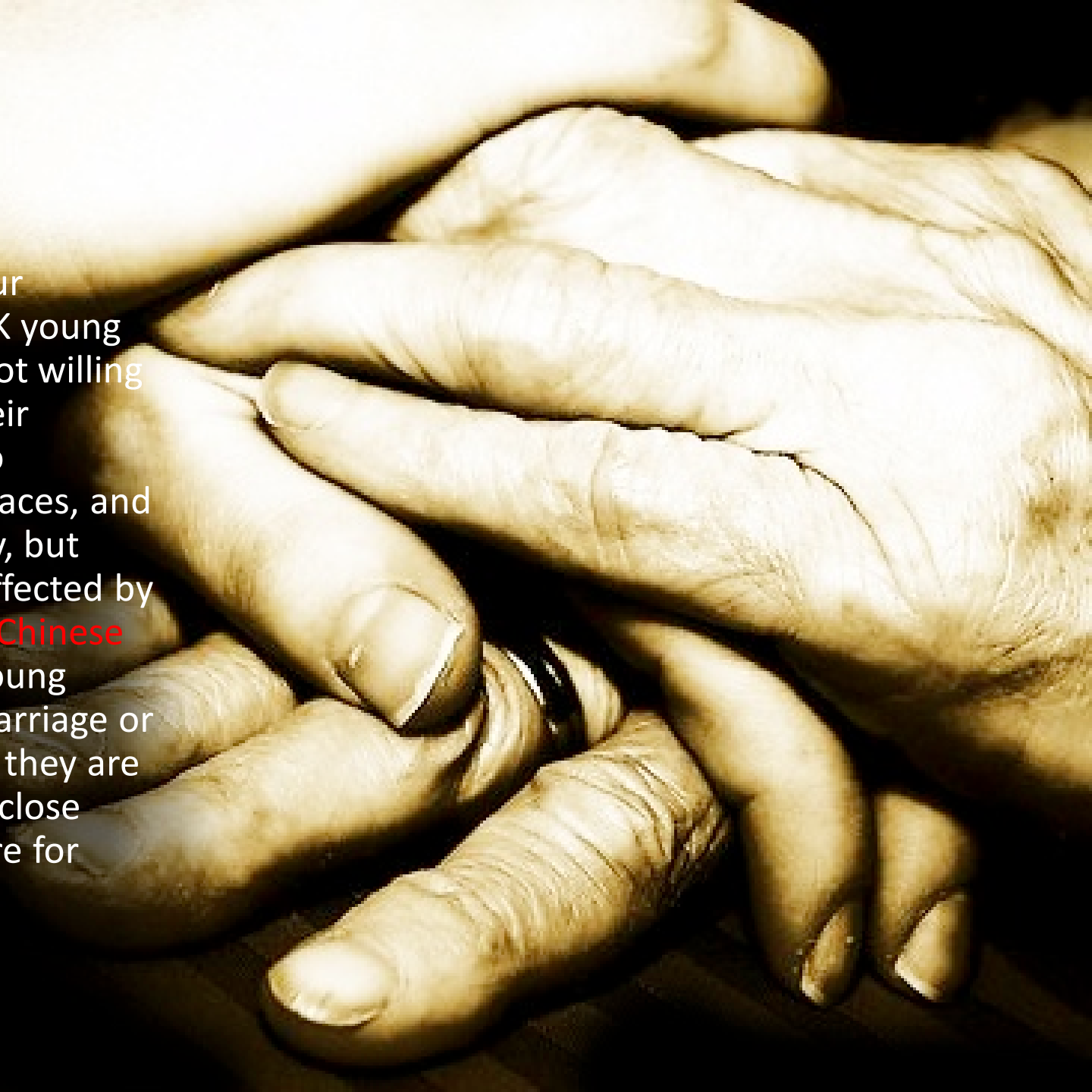

-**Social Interaction** (David Harvey) is important to multi “ Active Ageing” communities.

- In modern cities, we have to create catalysts to conduce an interactive process to organize the complex system to transform spaces to support and develop active ageing communities.

A close-up, high-resolution photograph of an elderly person's face, showing deep wrinkles and a warm, joyful smile. The person's eyes are slightly squinted, and their mouth is open in a genuine expression. The skin has a rich, warm tone. The background is dark and out of focus.

The Way

- To satisfy the Nursing Care Need
- To attain the aim of “Ageing in Place”
- To establish “Elderly-valued Family”
- To construct Community Network

Architect as Social Reformer

- 3 Spatial Research/ Design Levels:

1. Interior Renovation
2. Architectural Design
3. Urban Design





- Elderly Rental Housing is small and its design is inappropriate.

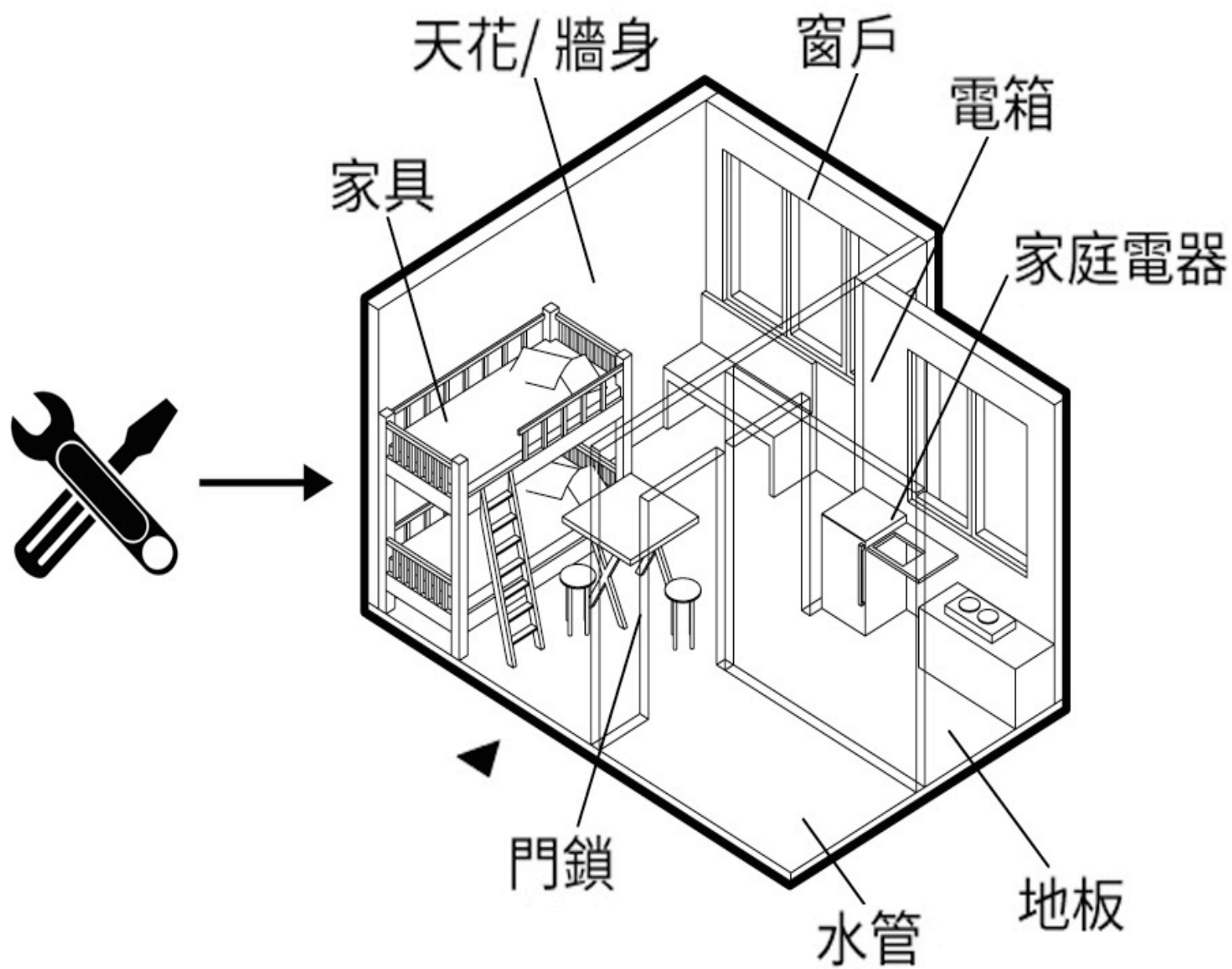

Pilot Scheme

試點計劃



Tenant's Original Flat

住戶原有單位

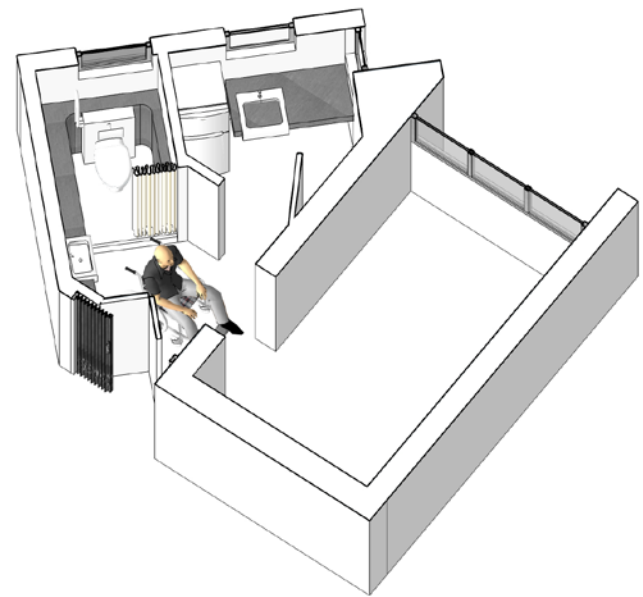

Design Discussion with Tenant

與住戶討論設計



Design Model

設計模型



Design 設計



Bathroom Wall
Material
浴室牆身物料



Improved Storage
Door
改善儲物櫃櫃門



Wall Painting
壁畫



Wood-pattern
Flooring
木紋地板物料



Elderly Friendly
Bathroom
長者友善浴室



Anti-slip Flooring
Material
防滑地板物料



Light-stripe at
edge of Bed
睡床旁燈帶

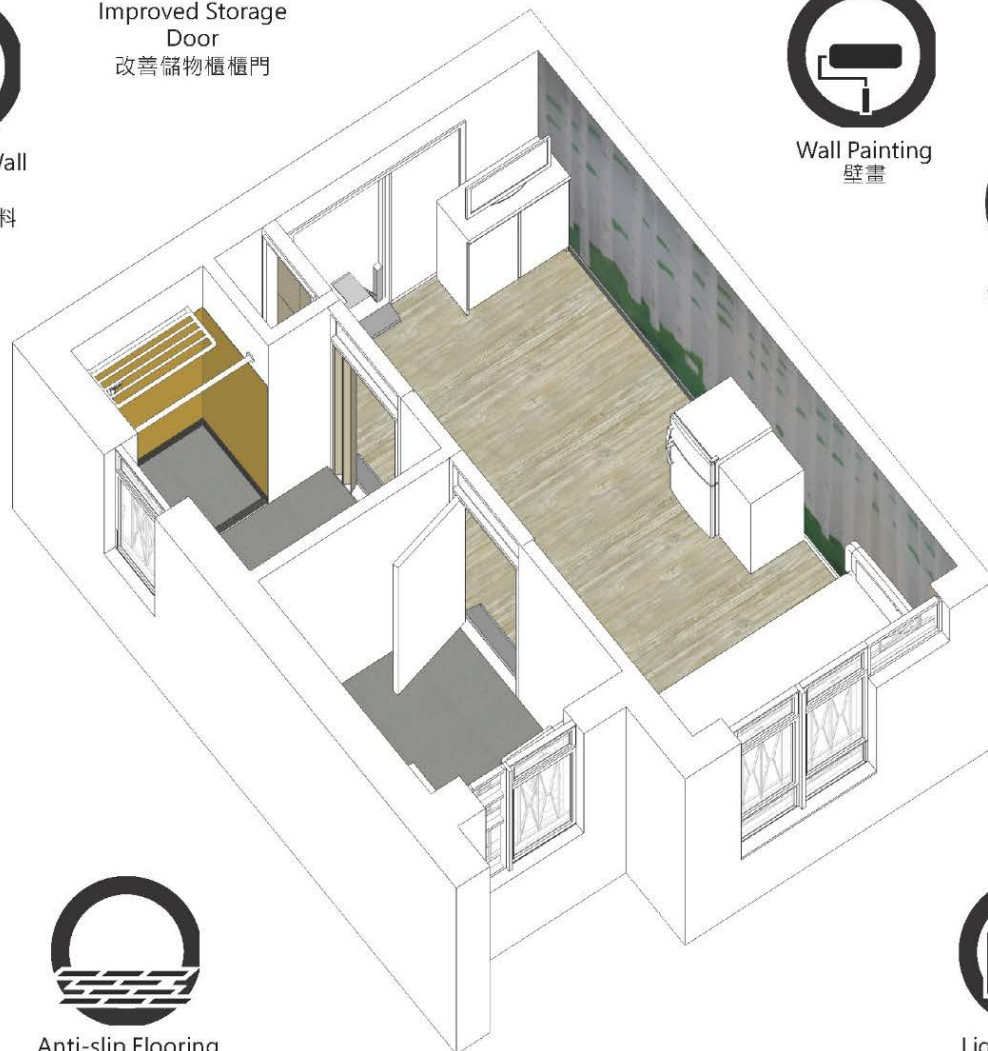



Kitchen

廚房

Renovated Flat

改善後新單位



Wall paint

壁畫





Bathroom

浴室



Bathroom

浴室



Storage

儲物空間

Smart Lighting System

智能照明系統



Entrance Ramp

入口斜台





Electric Ramp

電動入口斜台

*Prototype, currently undergoing further design research with Housing Department

Electric Ramp (Video)

電動入口斜台 (影片)

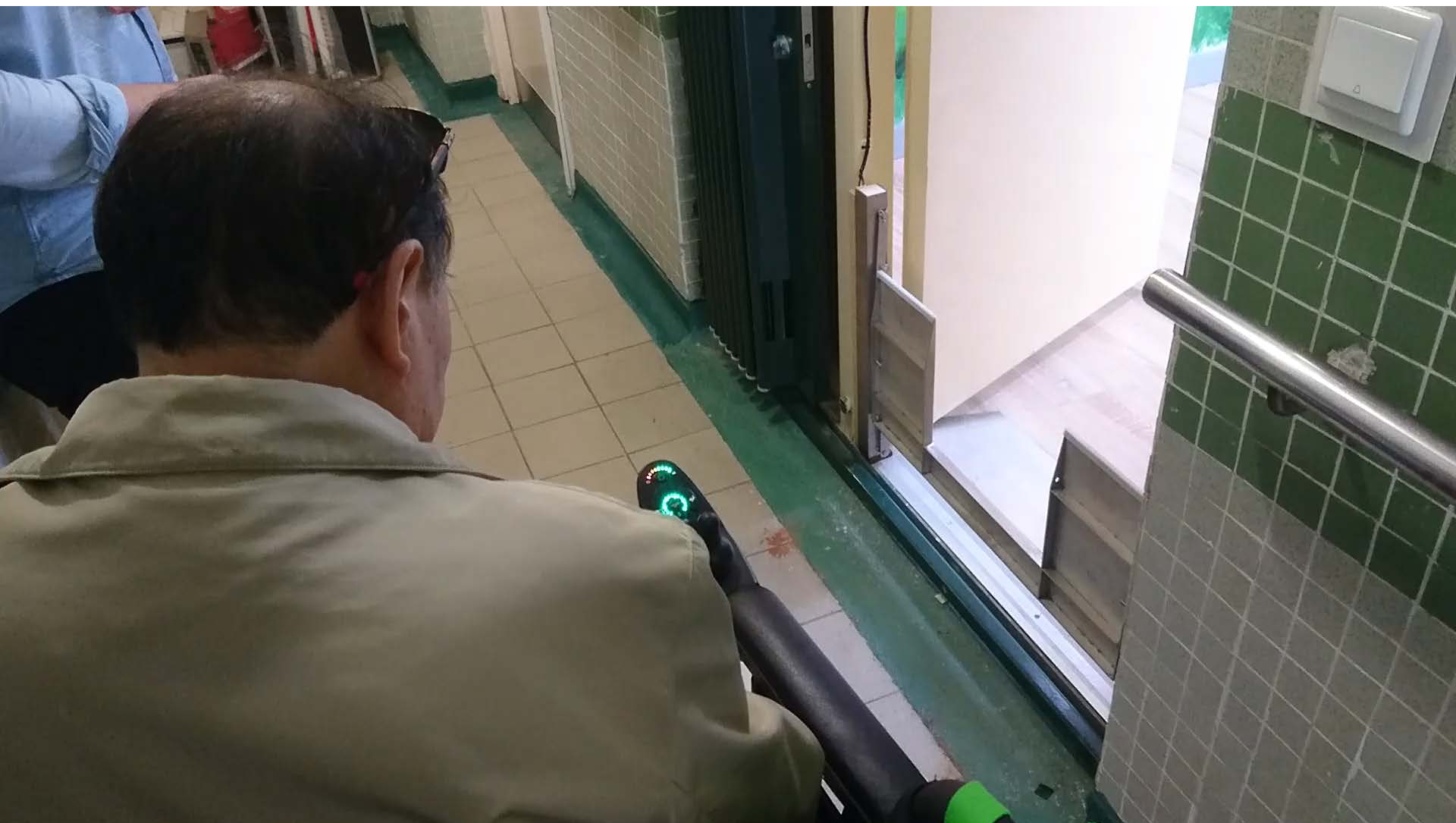

Housing Moving Volunteer

學生義工協助搬屋



Thank you for the support from HA

感謝房屋署的支持



Project Team

計劃團隊



Application 2

- HEYA is an urban redevelopment (Housing Society) to integrate elderly home (contract home) + young nuclear family.





- 100-bed (80 government, 20 private) elderly home
- Around 240 saleable residential unit

A street-level view of a busy urban area in Hong Kong. Tall buildings line both sides of the street. On the right, a prominent building has vertical Chinese characters '中興工業大廈' and 'CHUNG HING INDUSTRIAL MANSION'. A blue building on the far right has a sign for '優質物業' (Quality Property). A semi-transparent grey box is overlaid on the left side of the image, containing text. A large green question mark is in the top left corner.

HK has 1,000,000 sq.m. Vacant industrial spaces.

If policy allows, the shortage of elderly rooms may be relaxed within a short time.

Physical Model

- Youth + Elderly Housing Proposal

MARch Thesis, CUHK

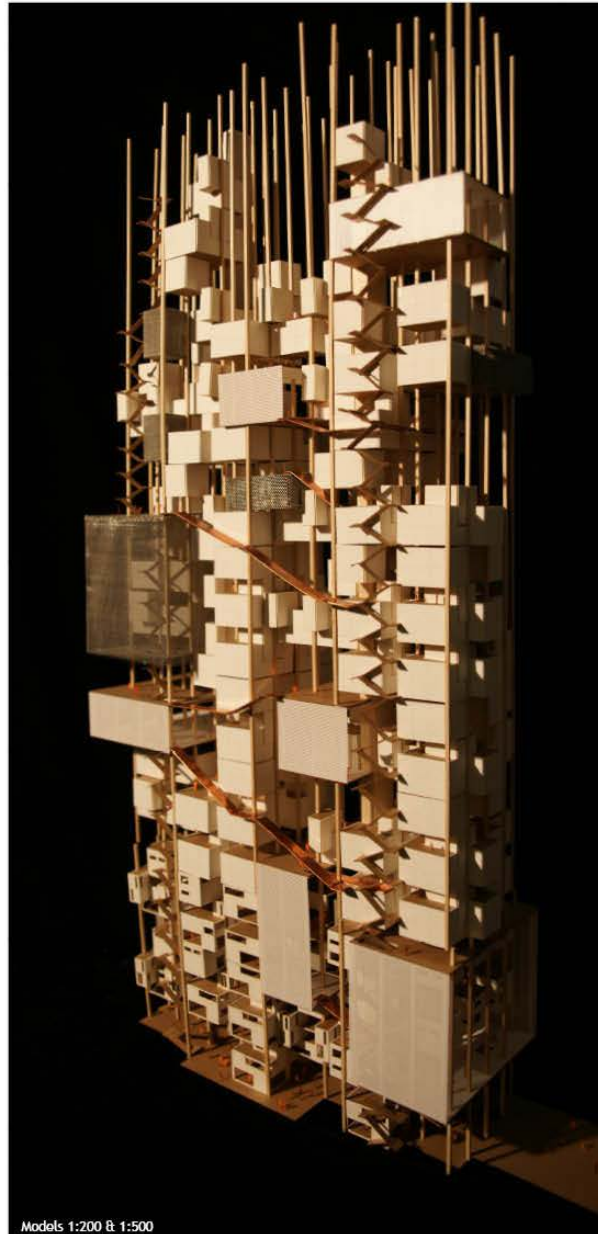

Models 1:200 & 1:500



Courtyard on GL

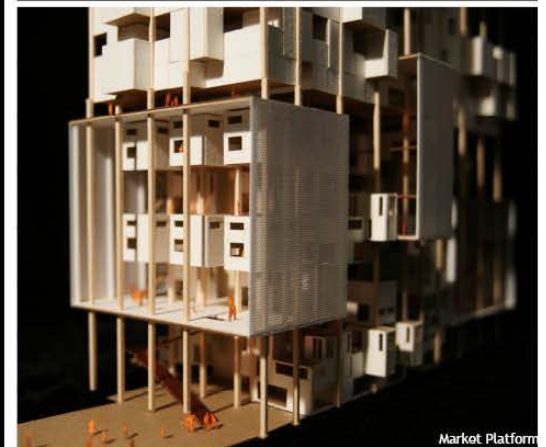

Market Platform



Cultural Platform

Application 3

- Dills Corner Garden is a cluster of private-operated elderly homes.
- Due to the new development plan, they are subject to give way for roads and commercial developments.





- By re-designing the layout, continuous liaison with parties, elderly homes + clinical building are provided.



Multi-welfare Services Complex in Kwu Tung North

Application 4

- E-PATHY CITY
- Built upon the experience of Kai Tak River and its transformed concept of cultural mapping, an urban placemaking concept is generated to integrate Elderly, Art, & Green into an urban system.



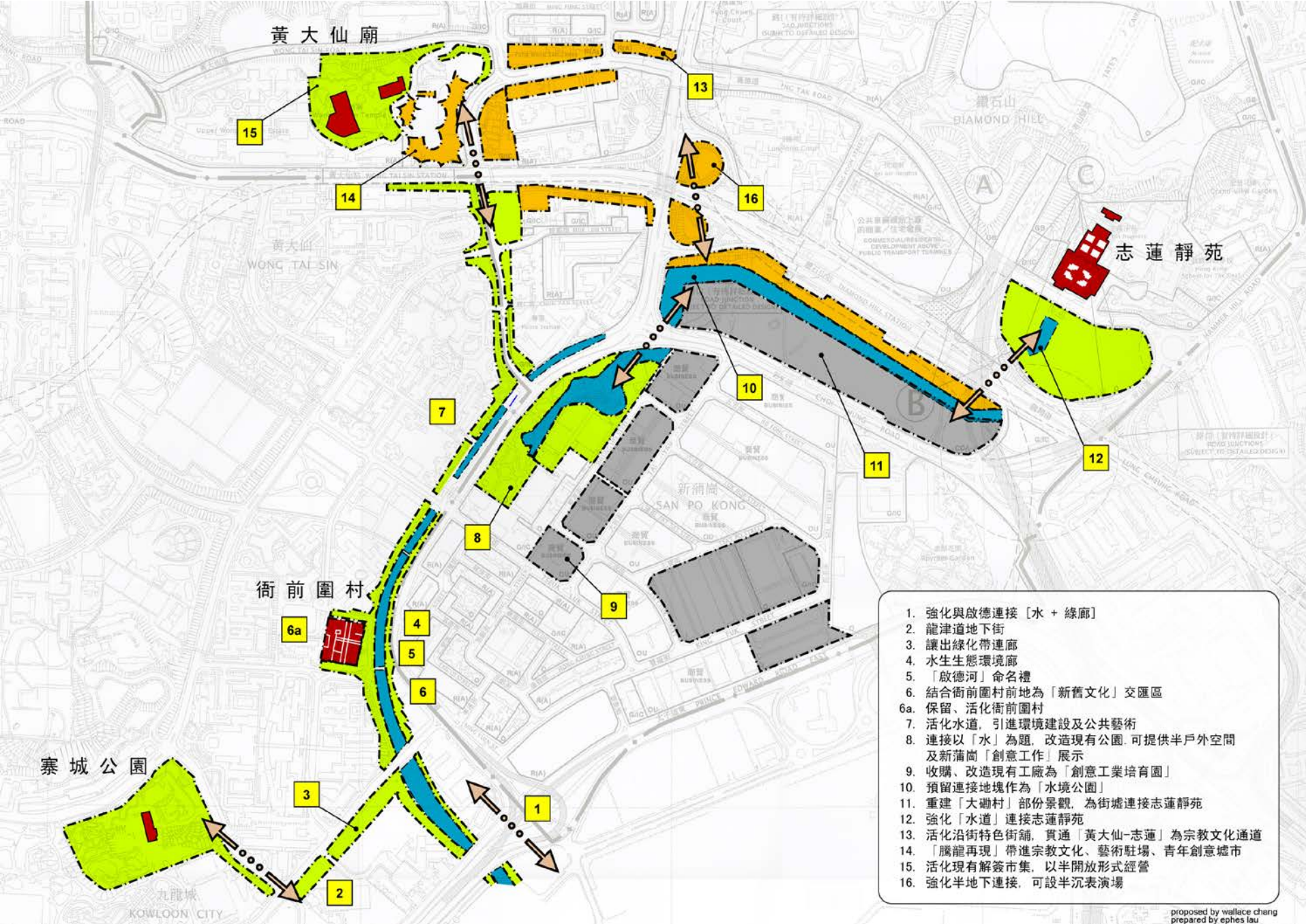

1. 強化與啟德連接 [水 + 綠廊]
2. 龍津道地下街
3. 讓出綠化帶連廊
4. 水生生態環境廊
5. 「啟德河」命名禮
6. 結合衙前圍村前地為「新舊文化」交匯區
- 6a. 保留、活化衙前圍村
7. 活化水道，引進環境建設及公共藝術
8. 連接以「水」為題，改造現有公園，可提供半戶外空間及新蒲崗「創意工作」展示
9. 收購、改造現有工廠為「創意工業培育園」
10. 預留連接地塊作為「水境公園」
11. 重建「大磡村」部份景觀，為街墟連接志蓮靜苑
12. 強化「水道」連接志蓮靜苑
13. 活化沿街特色街舖，貫通「黃大仙-志蓮」為宗教文化通道
14. 「騰龍再現」帶進宗教文化、藝術駐場、青年創意墟市
15. 活化現有解糞市集，以半開放形式經營
16. 強化半地下連接，可設半沉表演場

總圖



活化啟德河的構思—
「水．綠．文物觀景徑」計劃

Wong Tai Sin Ci & Temple

Chi Lin Nunnery

Water Park /
Qiao Hong Old Home

Nga Tsin Wai Village

Kai Tak River

Kowloon Walled City

Cattle Depot Artist Village

Hoi Sum Park

Heritage Trail
Livelihood Trail



4.3.4 As Cross-disciplinary Subject Resources:

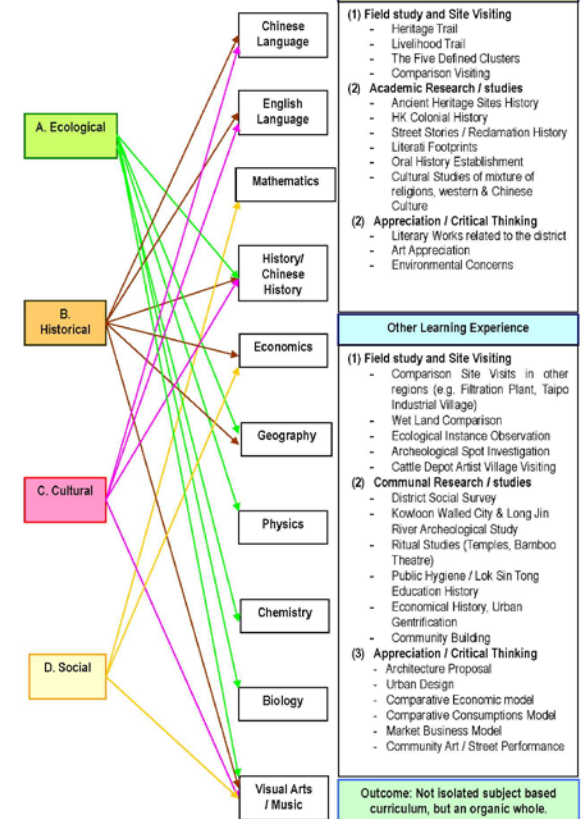

QEF Proposal



東匯範圍內的藝術裝置





E-Station

- cultural mapping



Connectivity Urban Arc-tion

A series of research-based architectural and art actions that aim to arouse interest in and awareness of urban space in a real community.





Dai Mui





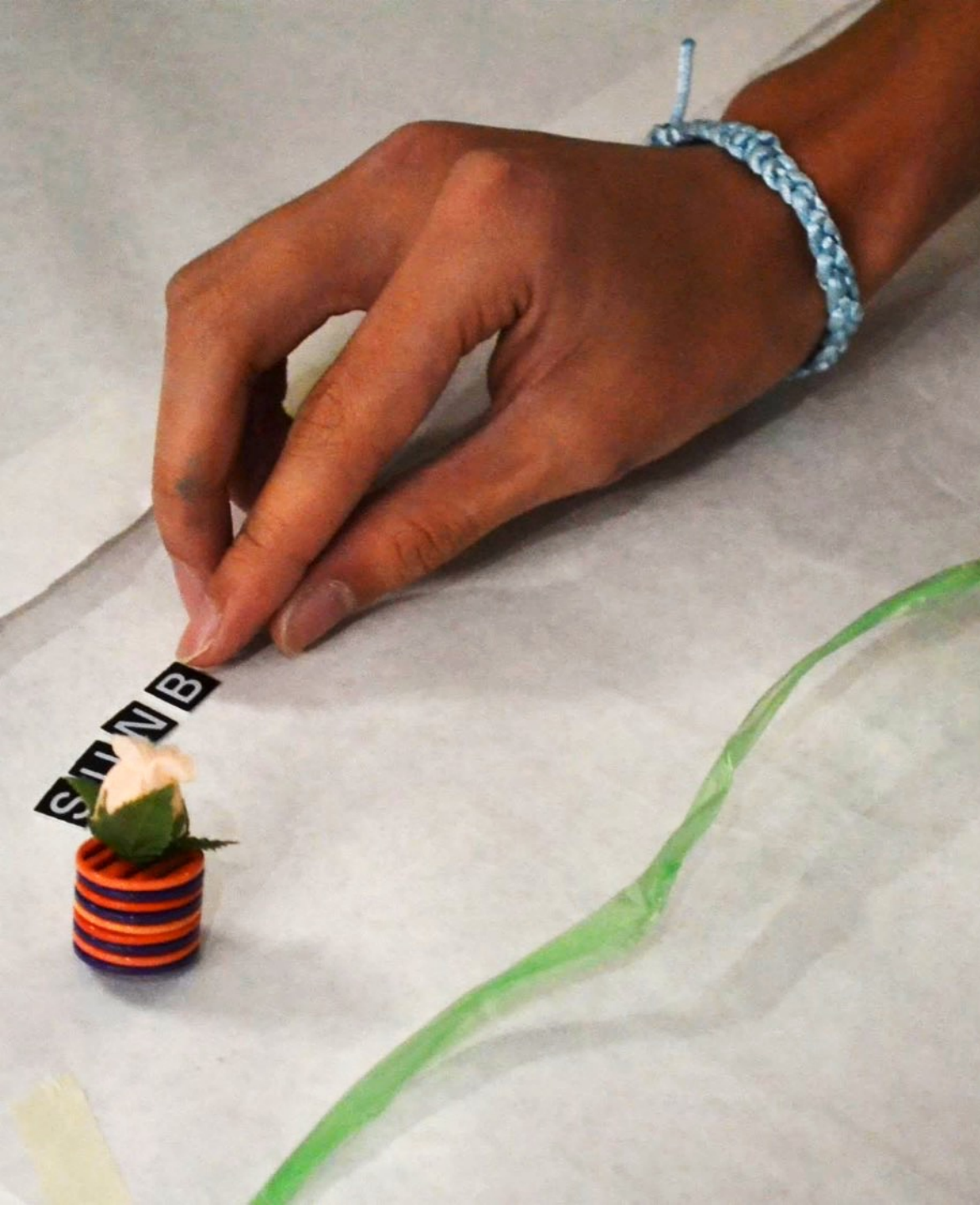

Intervention and interflow

In phase 2 of E-pathy City, a series of workshops under the concept of Intervention and interflow will be organized to explore and experiment the concept of Empathy City through discussions and interactions. Participants will be challenged to use their own language to construct the theoretical framework of the Empathy concept.



Our Digital Stories , June 2015



"Community Kitchen: Finale Gala Party" 07 March 2015



“E-Pathy City- Green-Net-Working (III)”
16 Jan 2016



- Through the design/ research approach in urban intervention, it is aimed to achieve “Ageing in Place”.
- Active Ageing is meant to reconnect communities through urban design and facilities to allow an “Intergenerational Dependency”.
- To elevate the idea of Active Ageing towards “Social Innovation”, e.g. E-pathy City, thus enhancing the ageing community to achieve a higher goal in life.